

ORBIS™ RAIL MOUNTING CLAMP INSTALLATION INSTRUCTIONS

Ensure that all relevant personnel read the points listed below and that a copy is passed on to staff involved with the installation. Please also refer to the 'Manual Handling Operations Regulations 1992' during the handling of the product and materials used for installation.

KIT CONTENTS:

ITEM 1	Clamp plate	x2
ITEM 2	M8 x 35mm screw	x4
ITEM 3	M8 x 80mm screw	x8
ITEM 4	M8 x 20mm washer	x16
ITEM 5	M8 Nyloc Nut	x8

TOOLS REQUIRED:

5mm Allen Key
13mm Ring Spanner

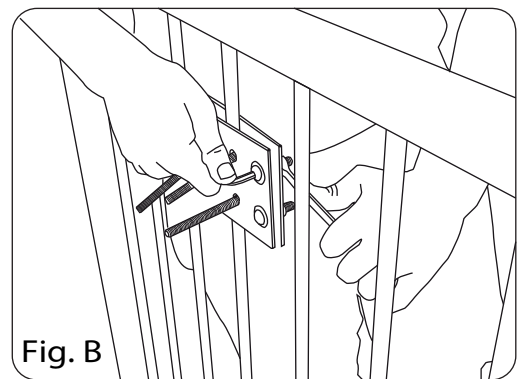
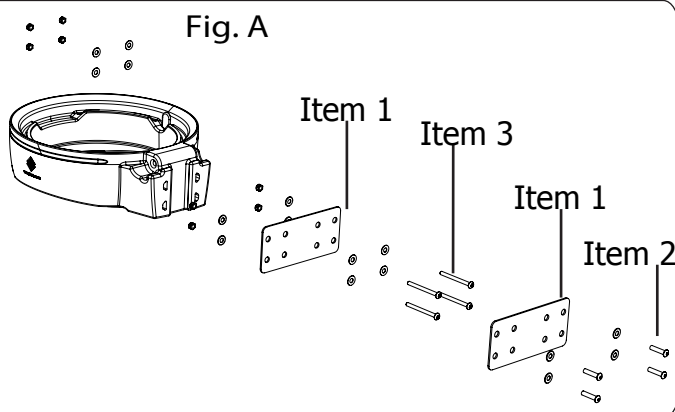
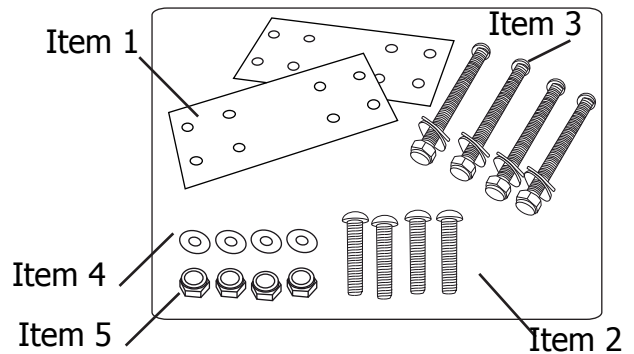

1. First, place one clamp plate (Item 1) on the side of the railing you want to place the Orbis. Then slot the M8 x 80mm screw (Item 3) through the four inner most holes of it, through the railings. Next, position the other clamp plate and slot 4 M8 x 35mm screws (Item 2) through the outer holes of both clamp plates (Item 1), (See Fig A.) When all the screws and plates are lined up tighten the outer screws using 4 M8 x 20mm washers (Item 4), 4 M8 Nyloc Nuts (Item 5), a 5mm Allen Key and a 13mm Ring Spanner, until tight. (Fig B).

Please Note: we have provided 8 M8 x 80mm screws as these may be required if fixing to a wider rail instead of the M8 x 35mm screws.

2. Next, line up the 4 holes on the back of the Orbis body with the 4 screws left unfastened. Slot the Orbis onto these screws (Fig C) and tighten the screws using 4 M8 x 20 washers, 4 M8 Nyloc Nuts (Item 5), a 5mm Allen Key and a 13mm ring spanner. (See Figs D + E).

